



DWV Long Radius Elbows

100mm

- Available in 80, 88 & 45 Degrees.
- Reduces Hydraulic Jump.
- Assists in eliminating blockages due to reduced flow.
- Compliant to prescribed radius in AS/NZ3500.02, when installed at base of stacks.
- Ideal for Civil & with "Reactive Soils".

Long Radius

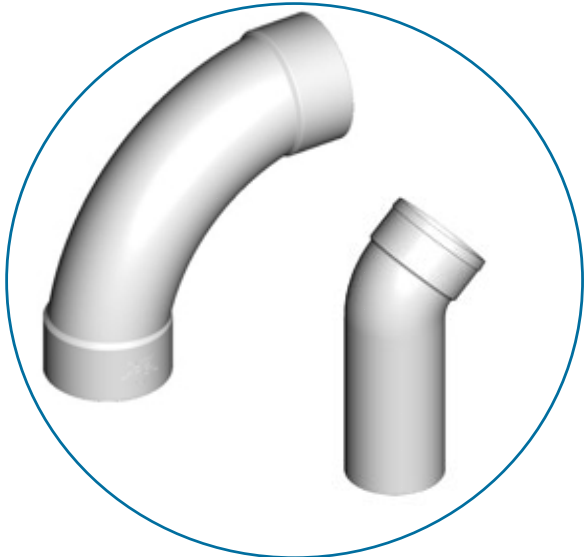

17230 - 294 mm
18949 - 289.8 mm
17408 - 333.3mm

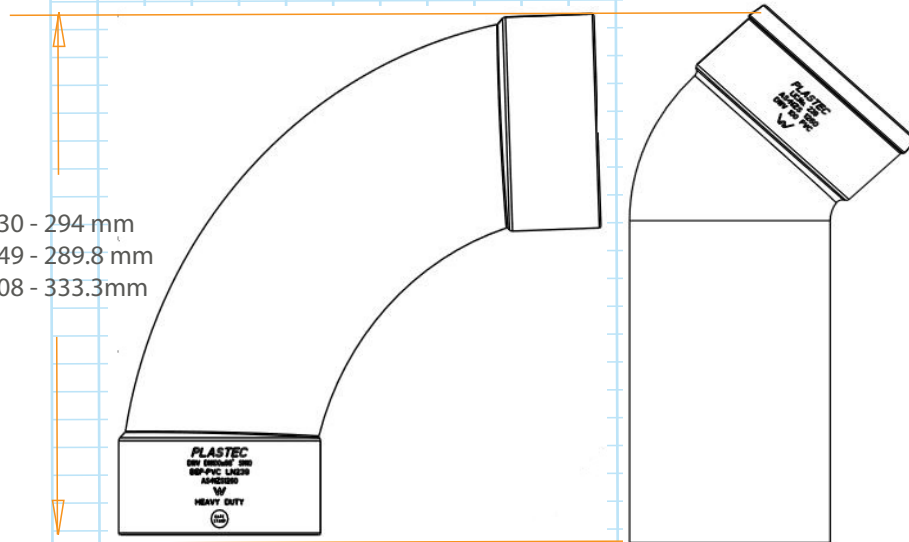

Wall Thickness
17230 - 5 mm
18949 - 3.5 mm
17408 - 3.5 mm

Measurements (mm)

17230 - 120.75 mm
18949 - TBA

17408 - 120.5mm

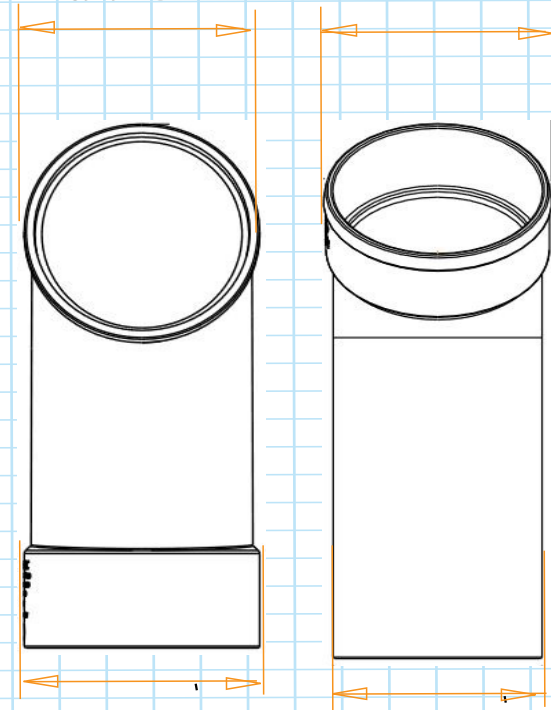

17230 - 120.75 mm
18949 - TBA

17408 - 110.2mm

ID	Ø		CTN QTY	
17230	100mm	F&F	88 Degree	10
18949	100mm	F&F	80 Degree	15
17408	100mm	M&F	45 Degree	20

