



What does it cost your business to replace cracked fittings?

NOW THERE IS AN ALTERNATIVE...

## CivilTec Super Heavy Duty DWV

Plastec is introducing a new, extensive range of Super Heavy Duty DWV fittings for all your commercial plumbing needs.

This complete range includes bends, junctions, reducing junctions, inspection pieces and Level Invert Tapers.

- Designed with additional thickness than standard DWV fittings.
- All products feature an additional support gusset for added strength.

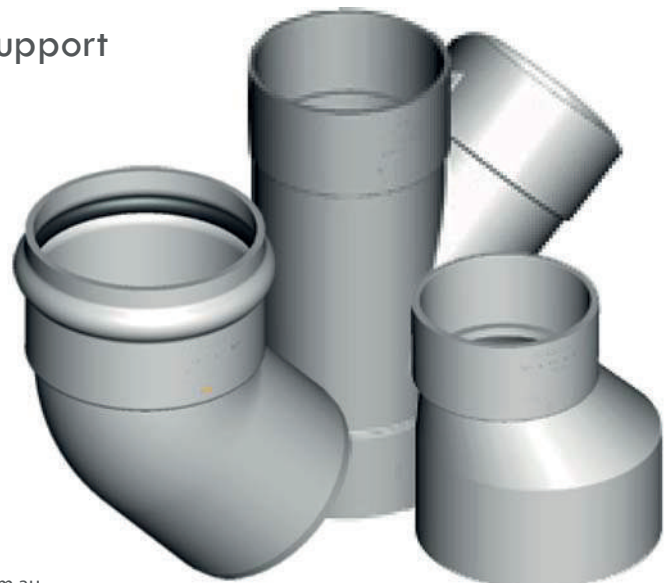

## Bends

### 43 Degrees



#### Rubber Ring Joint x 1 - M/F

| ID    | Ø(MM) | W(MM) | CTN |
|-------|-------|-------|-----|
| 19656 | 100   | 5     | 20  |
| 19402 | 150   | 6     | 11  |



#### Solvent Weld - M/F

| ID    | Ø(MM) | W(MM) | CTN |
|-------|-------|-------|-----|
| 18781 | 100   | 5     | 30  |
| 18842 | 150   | 6     | 12  |

### 45 Degrees



#### Solvent Weld - F/F

| ID    | Ø(MM) | W(MM) | CTN |
|-------|-------|-------|-----|
| 19334 | 100   | 5     | 26  |
| 19331 | 150   | 6     | 12  |



#### Rubber Ring Joint x 2 - F/F

| ID    | Ø(MM) | W(MM) | CTN |
|-------|-------|-------|-----|
| 19501 | 100   | 5     | 16  |
| 19414 | 150   | 6     | 10  |

### 60 Degrees



#### Solvent Weld - F/F

| ID    | Ø(MM) | W(MM) | CTN |
|-------|-------|-------|-----|
| 19489 | 100   | 5     | 31  |

### 88 Degrees



#### Solvent Weld - F/F

| ID    | Ø(MM) | W(MM) | CTN |
|-------|-------|-------|-----|
| 19335 | 100   | 5     | 18  |
| 19332 | 150   | 6     | 8   |

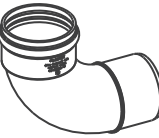

#### Rubber Ring Joint x 1 - M/F

| ID    | Ø(MM) | W(MM) | CTN |
|-------|-------|-------|-----|
| 19400 | 150   | 6     | 6   |



#### Rubber Ring Joint x 2 - F/F

| ID    | Ø(MM) | W(MM) | CTN |
|-------|-------|-------|-----|
| 19416 | 150   | 6     | 6   |

## Inspection Opening Pipes

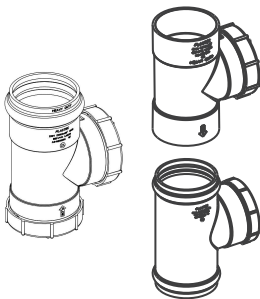

#### Solvent Weld - F/F & \* RRJ/Solvent Weld

| ID     | Ø(MM) | W(MM) | CTN |
|--------|-------|-------|-----|
| 19324  | 100   | 5     | 14  |
| 19689* | 100   | 5     | 13  |
| 19327  | 150   | 6     | 7   |

#### Rubber Ring Joint x 2 - F/F

| ID    | Ø(MM) | W(MM) | CTN |
|-------|-------|-------|-----|
| 19427 | 150   | 6     | 6   |

## Level Invert Tapers



#### Solvent Weld - M/F

| ID    | Ø(MM)   | W(MM) | CTN |
|-------|---------|-------|-----|
| 19330 | 150x100 | 6     | 20  |

## Socket Adaptor Threaded

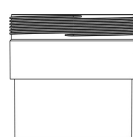

#### Threaded Connector

| ID    | Ø(MM) | W(MM) | CTN |
|-------|-------|-------|-----|
| 19701 | 100   | 5     | 48  |
| 19702 | 150   | 6     | 24  |

KEY: Ø (MM) - DIAMETER W (MM) - WALL THICKNESS

## Junctions

### 45 Degrees

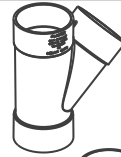

#### Solvent Weld - F/F

| ID    | Ø(MM) | W(MM) | CTN |
|-------|-------|-------|-----|
| 19321 | 100   | 5     | 12  |
| 19322 | 150   | 6     | 5   |

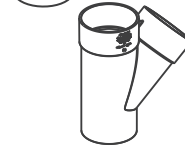

#### Solvent Weld - M/F

| ID    | Ø(MM) | W(MM) | CTN |
|-------|-------|-------|-----|
| 19622 | 150   | 6     | 5   |



#### Rubber Ring Joint x 2 - M/F

| ID    | Ø(MM) | W(MM) | CTN |
|-------|-------|-------|-----|
| 19397 | 150   | 6     | 4   |

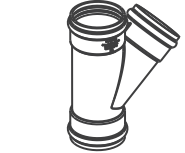

#### Rubber Ring Joint x 3 - F/F

| ID    | Ø(MM) | W(MM) | CTN |
|-------|-------|-------|-----|
| 19412 | 150   | 6     | 4   |



### 88 Degrees

#### Solvent Weld - F/F

| ID    | Ø(MM) | W(MM) | CTN |
|-------|-------|-------|-----|
| 19499 | 100   | 5     | 16  |



#### Rubber Ring Joint RILEY Junction - F/F

| ID    | Ø(MM) | W(MM) | CTN |
|-------|-------|-------|-----|
| 19692 | 150   | 5     | 4   |

## Reducing Junctions

### 45 Degrees



#### Solvent Weld - F/F

| ID    | Ø(MM)   | W(MM) | CTN |
|-------|---------|-------|-----|
| 19323 | 150x100 | 6     | 5   |



#### Solvent Weld - M/F

| ID    | Ø(MM)   | W(MM) | CTN |
|-------|---------|-------|-----|
| 19623 | 150x100 | 6     | 7   |



#### Rubber Ring Joint x 2 - M/F

| ID    | Ø(MM)   | W(MM) | CTN |
|-------|---------|-------|-----|
| 19442 | 150x100 | 6     | 5   |



#### Rubber Ring Joint x 3 - F/F

| ID    | Ø(MM)   | W(MM) | CTN |
|-------|---------|-------|-----|
| 19444 | 150x100 | 6     | 5   |

## Couplings



#### Rubber Ring Joint x 2 - F/F

| ID    | Ø(MM) | W(MM) | CTN |
|-------|-------|-------|-----|
| 19420 | 150   | 6     | 17  |

## Slip Couplings



#### Rubber Ring Joint x 2 - F/F

| ID    | Ø(MM) | W(MM) | CTN |
|-------|-------|-------|-----|
| 19418 | 150   | 6     | 14  |